

## Synthetic locking plug

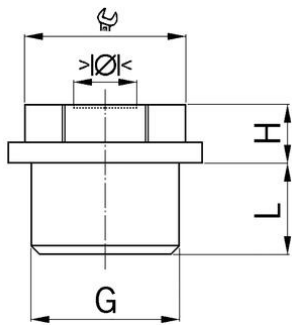

### Entry thread metric

- Light grey RAL 7035
- with bore hole

<b>Order number:</b>	<b>1620.32</b>
EAN:	7611614129358
Material	Polyethylene
Operation temperature	-20°C / +70°C
Protection class	IP 54
Entry thread	M32x1.5
Clamping range without insert min.	11.0 mm
Clamping range without insert max.	22.0 mm
Wrench size	30 mm
Dimension H	11 mm
Thread length L	14 mm
Dispatch	50